

**Specifications**

Nominal Voltage		12 V
Capacity (25°C)	20HR(10.5V)	1.4Ah
	10HR(10.5V)	1.3Ah
	1HR(9.60V)	0.91Ah
Dimension	Length	97 ± 1mm (3.82inch)
	Width	43 ± 1mm (1.69inch)
	Height	52 ± 1mm (2.05inch)
	Total Height	58 ± 1mm (2.28inch)
Approx. Weight		0.55kg (1.21lbs) ± 5%
Terminal type		T1
Internal resistance (Fully charged, 25°C)		Approx. 70mΩ
Capacity affected by temperature (20HR)	40°C	102%
	25°C	100%
	0°C	85%
	-15°C	65%
Self-discharge (25°C)	3 month	Remaining Capacity: 91%
	6 month	Remaining Capacity: 82%
	12 month	Remaining Capacity: 65%
Nominal operating temperature		25°C ± 3°C (77°F ± 5°F)
Operating temperature range	Discharge	-15°C ~ 50°C (5°F ~ 122°F)
	Charge	-10°C ~ 50°C (14°F ~ 122°F)
	Storage	-20°C ~ 50°C (-4°F ~ 122°F)
Float charging voltage(25°C)	13.60 to 13.80V Temperature compensation: -18mV/°C	
Cyclic charging voltage(25°C)	14.50 to 14.90V Temperature compensation: -30mV/°C	
Maximum charging current	0.42A	
Terminal material	Copper	
Maximum discharge current	21A(5 sec.)	
Designed floating life(20°C)	10years	

**Dimensions**

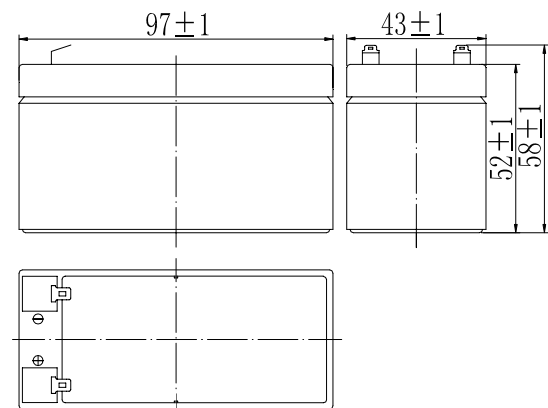

**Terminal**

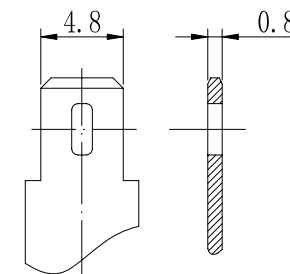

Terminal T1

- ◆ Absorbent glass mat technology;
- ◆ Recognized by UL & CE;
- ◆ ABS container.

**Constant Current Discharge Characteristics (A, 25°C)**

F.V/TIME	5min	10min	15min	30min	60min	2h	3h	4h	5h	10h	20h
9.60V	5.32	3.36	2.66	1.48	0.91	0.50	0.357	0.286	0.243	0.132	0.071
9.90V	5.16	3.26	2.60	1.45	0.90	0.49	0.355	0.284	0.241	0.132	0.071
10.2V	4.95	3.12	2.50	1.41	0.87	0.49	0.352	0.282	0.240	0.131	0.070
10.5V	4.73	2.99	2.42	1.38	0.86	0.48	0.350	0.280	0.238	0.130	0.070
10.8V	4.47	2.82	2.29	1.33	0.83	0.47	0.340	0.272	0.231	0.128	0.069

**Constant Power Discharge Characteristics (Watt, 25°C)**

F.V/TIME	5min	10min	15min	30min	60min	2h	3h	4h	5h	10h	20h
9.60V	59.4	37.9	30.3	17.0	10.5	5.82	4.24	3.40	2.90	1.59	0.85
9.90V	57.6	36.8	29.6	16.7	10.4	5.78	4.22	3.38	2.88	1.58	0.85
10.2V	55.2	35.2	28.5	16.2	10.1	5.73	4.19	3.36	2.86	1.57	0.85
10.5V	52.8	33.7	27.5	15.8	9.9	5.65	4.16	3.33	2.84	1.56	0.84
10.8V	49.9	31.8	26.1	15.2	9.6	5.50	4.03	3.23	2.76	1.53	0.82

Note: The above characteristics data can be obtained within three charge/discharge cycles.

**Discharge Characteristics(25°C)**

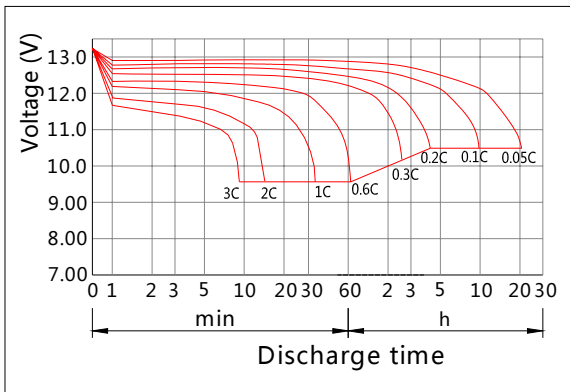

**Charging Characteristics(25°C)**

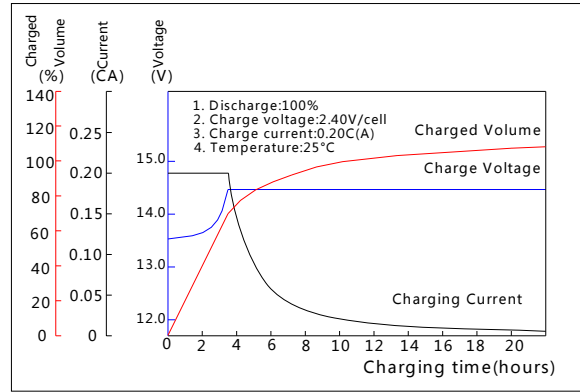

**Effect of Temperature on Capacity**

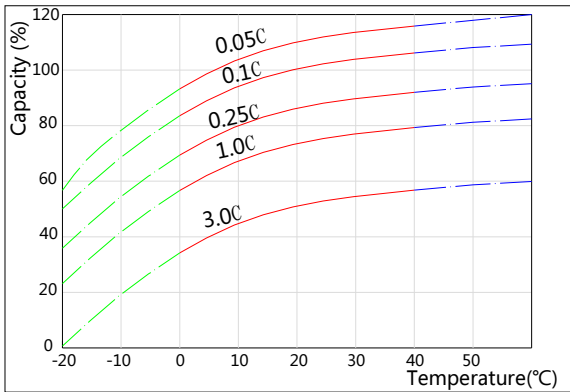

**Self-discharge Characteristics**

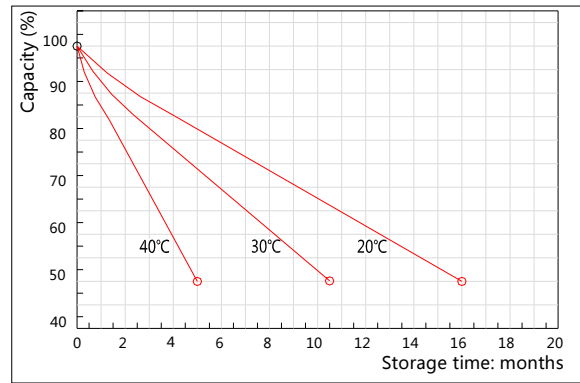

**The Relationship for Open Circuit Voltage and Residual Capacity (25°C)**

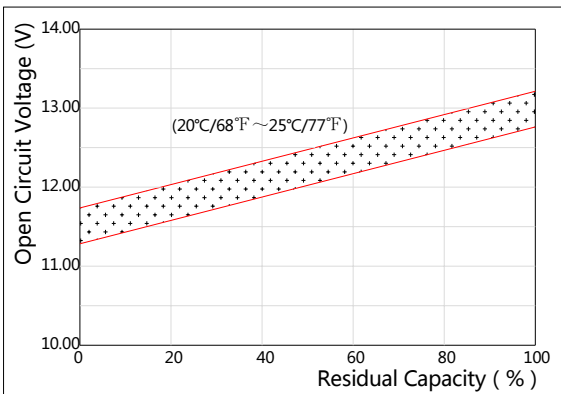

**The Relationship for Charging Voltage and Temperature**

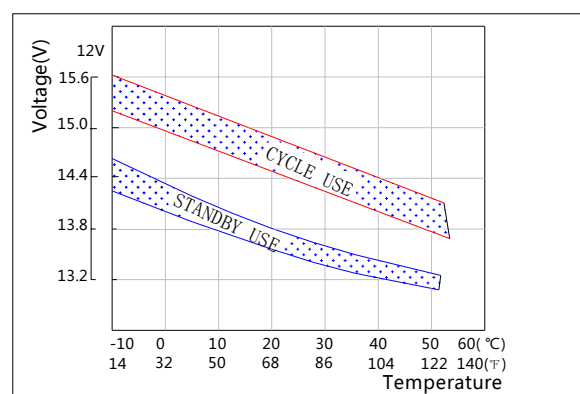

**Floating Life on Temperature**

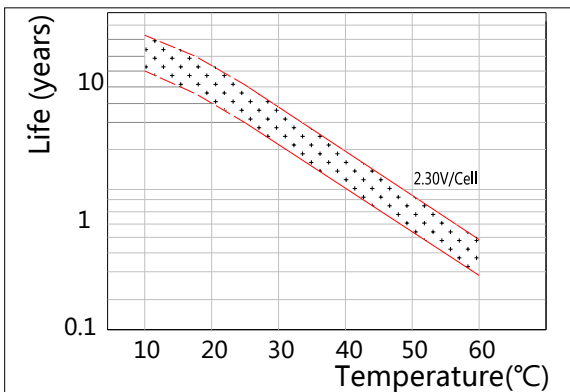

**Cycle Life on D.O.D(25°C)**

