

**OPzV Series SLA Battery**

**Opzv Series**

BSB Opzv Series Valve Regulated Lead Acid batteries are designed with a proven combination of GEL and Tubular technologies to offer a very high lever of reliability. Opzv batteries benefit from an optimized plate design which gives capacities in excess of the DIN standard values. In addition, this series offers both a longest float life and a high cycle life in widely industrial field.

**Application**

- Telecommunications
- Cable Television
- Electric Utility
- Control Equipment
- Security System
- Medical Equipment
- UPS
- Railroad Utility
- Photovoltaic System
- Alternative Energy System

**General Features**

- Sealed and maintenance free operation.
- Non-Spillable construction design.
- ABS containers and covers(UL94HB, UL94V-0) optional.
- Safety valve installation for explosion proof.
- High quality and high reliability.
- Super long service life.
- Lowest self discharge characteristic.
- Super reliability.

**Construction**

- Component .....Raw material
- Positive .....Lead dioxide
- Negative .....Lead
- Container .....ABS
- Cover .....ABS
- Sealant .....Epoxy Resin
- Safety valve .....EPDR
- Terminal .....Copper
- Separator .....PVC-SiO<sub>2</sub>
- Electrolyte .....Sulfuric acid Thixotropic Gel

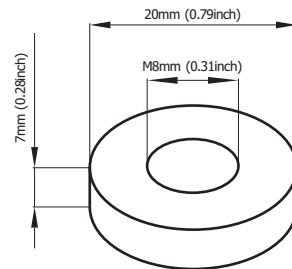

**Terminal Dimensions**

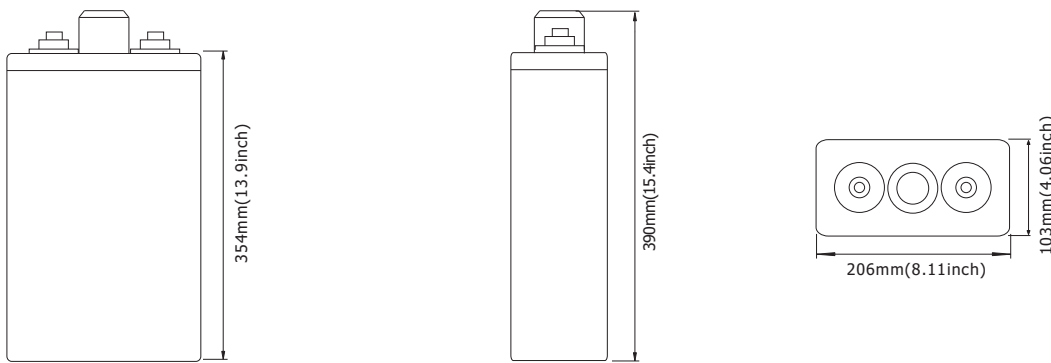

Battery Model	OPzV 2-100			
Designed Floating Life	20 Years			
Capacity(20°C)	20HR(.35A,1.80V)	10HR(10A,1.80V)	5HR(16.8A,1.80V)	1HR(51A,1.80V)
	107Ah	100Ah	84Ah	51Ah
Dimensions	Length	Width	Height	Total Height
	103mm(4.06inch)	206mm(8.11inch)	354mm(13.9inch)	390mm(15.4inch)
Approx. Weight	13.2Kg (29.1 lbs)			
Internal Resistance	Full charged at 20°C: 0.0011 Ohm			
Self Discharge	2% of capacity declined per month at (20°C)			
Capacity Affected by Temp.(20HR)	40°C	20°C	0°C	-15°C
	102%	100%	85%	65%
Charge Voltage(20°C)	Cycle use		Float use	
	2.3V-2.35V(-5mV/ °C), max. Current: 20A		2.25-2.27V(-3.3mV/ °C)	

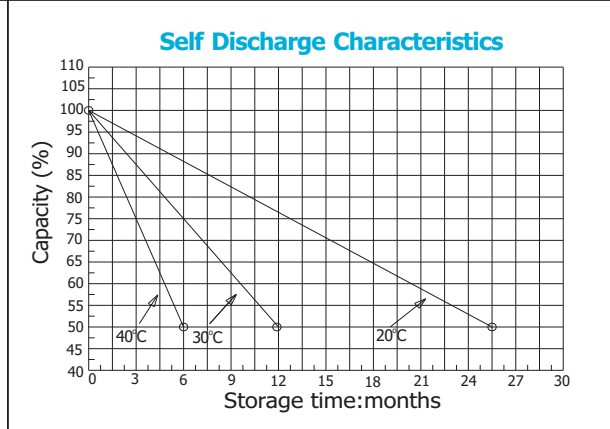
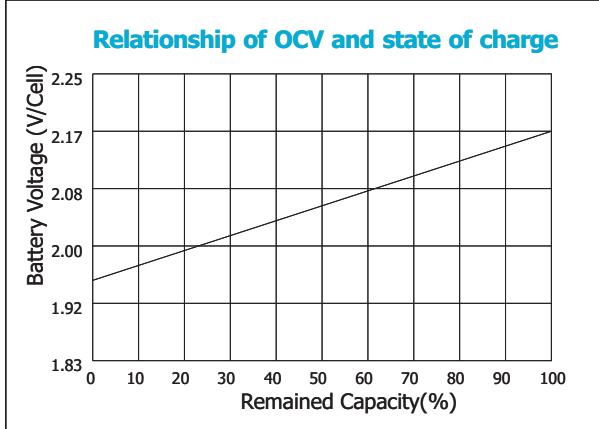
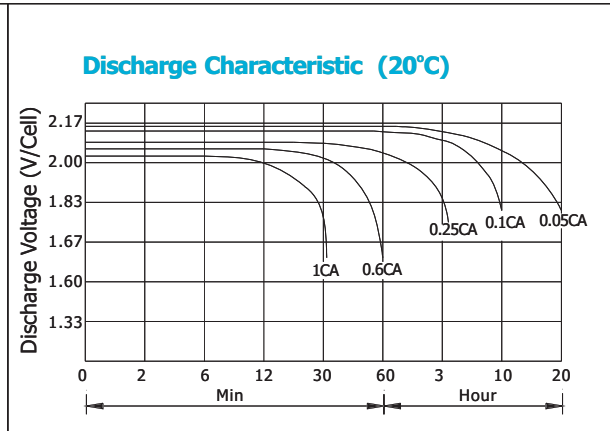
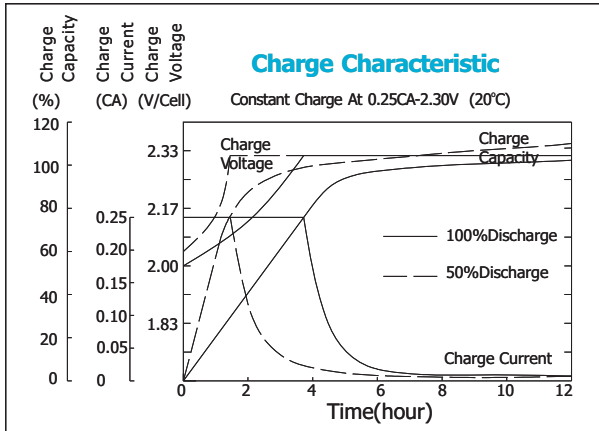

**Constant current discharge ratings-amperes at 20°C**

F.V/Time	15min	30min	1h	2h	3h	5h	8h	10h	20h
1.70V	125	86.0	55.5	33.4	25.0	17.3	12.0	10.5	5.50
1.75V	114	82.4	55.0	32.8	25.0	17.0	12.0	10.3	5.45
1.80V	101	76.8	51.0	31.8	25.0	16.8	11.8	10.0	5.35
1.83V	92.8	72.8	49.3	31.0	23.5	16.3	11.5	9.75	5.25
1.87V	81.8	66.0	45.8	29.3	22.3	15.8	10.8	9.25	5.15
1.90V	73.8	60.0	42.5	27.5	21.0	15.0	10.3	9.00	5.05

**Constant power discharge ratings-watts at 20°C**

F.V/Time	15min	30min	1h	2h	3h	5h	8h	10h	20h
1.70V	208	148	117	60.5	50.2	37.8	25.7	21.5	11.8
1.75V	184	144	106	59.1	50.1	36.9	25.2	20.4	11.5
1.80V	163	138	96.9	59.8	49.5	36.0	24.3	19.9	11.1
1.83V	156	130	92.5	59.5	49.1	35.1	23.9	19.5	10.9
1.87V	145	122	90.5	58.8	48.0	34.7	22.7	18.8	10.8
1.90V	138	110	86.9	56.3	46.3	33.5	22.3	18.2	11.0

