

## Specifications

Model NO.	YB9-BS	
Same DimensionsAs YUASA Model		
Nominal Voltage	12V	
Rated Capacity(10 hours rate)	9 AH	
Dimension	Length	135 mm (5.31 inches)
	Width	76 mm (2.99 inches)
	Height	137 mm (5.39 inches)
	Total Height	137 mm (5.39 inches)
Approx. Weight W/O . ACID	2.25 kg (4.96 Lbs)	
Approx. ACID Per Battery	0.50 L	
Charge Current (A)	0.9 A	

## Characteristics

Capacity 25°C(77°F)	10hours rate (0.9 A to 10.5V)	9.0 Ah	
	5hours rate (1.8 A to 10.2V)	7.65 Ah	
	1C (9.0 A to 9.6V)	4.05 Ah	
	3C (27.0 A to 9.6V)	3.24 Ah	
Cold Cranking Amperes(-18°C SAE Standard)		90 A	
Cold Cranking Amperes(-18°C EN Standard)		135 A	
Internal Resistance(at 1KHz)		Approx.7.0m Ω	
Operating Temperature Range	Charge	0°C (32°F) to 40°C (104°F)	
	Discharge	-15°C (5°F) to 50°C (122°F)	
	Storage	-15°C (5°F) to 40°C (104°F)	
Life Expectancy (Cycle Use)	100% depth of discharge 200 cycles		
	80% depth of discharge 225 cycles		
	50% depth of discharge 500 cycles		
Charge Retention (shelf life) at 20°C (68°F)	1 month	92%	
	3 month	90%	
	6 month	80%	
Standby Use	3~5 years		
Case Material	PP		



## Dimensions

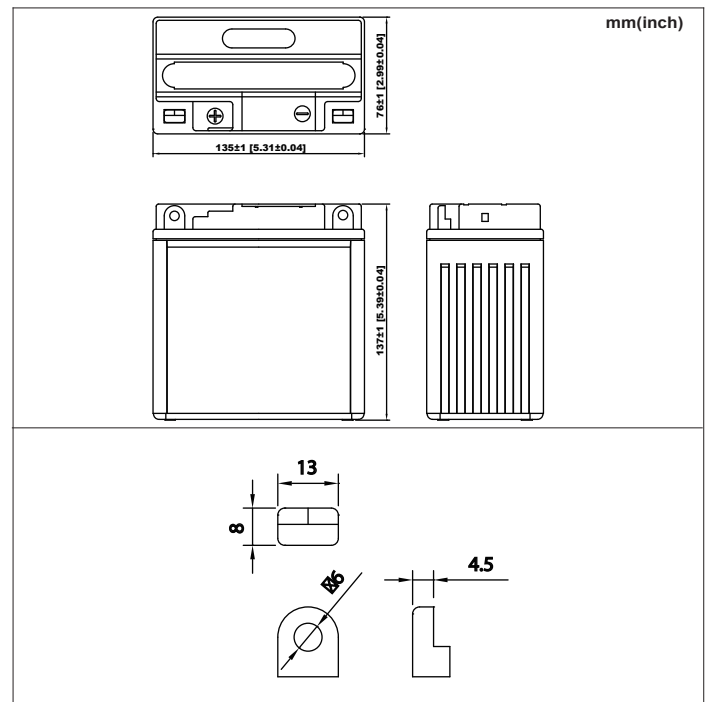

(V) FOR 12V BATTERY

## Discharge Time VS. Discharge Current(25 °C)

